

## SMD Power Inductors (NR series)

## NR4018T100M

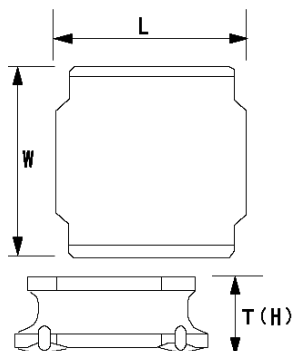

## ■ Features

- Item Summary  
10  $\mu$ H ( $\pm 20\%$ ), 1200mA, 840mA
- Lifecycle Stage  
Mass Production
- Standard packaging quantity (minimum)  
Taping 3500pcs

## ■ Products characteristics table

CaseSize (EIA/JIS)	~/4040
Inductance	10 $\mu$ H ( $\pm 20\%$ )
Inductance Measuring Frequency	100kHz
Rated Current -Saturation Current	1200mA
Rated Current -Temperature Rise Current	840mA
DC Resistance (max)	0.216 $\Omega$
Avg. of DC Resistance	0.18 $\Omega$
Self-resonant Frequency (min)	24MHz
RoHS Compliance	Yes
Halogen Free	Yes
Soldering Method	Reflow

## ■ External Dimensions

L	4mm $\pm 0.2$
W	4mm $\pm 0.2$
H	1.8mm max

## ■ Recommended Land Patterns

<b>【推奨ランドパターン】</b> 実装上の注意 ・実装状態を確認の上ご使用くださいませうお願いたします。 ・本製品のはんだ付けはリフローはんだ工法に限りませう。
<b>【Recommended Land Patterns】</b> Surface Mounting ・Mounting and soldering conditions should be checked beforehand. ・Applicable soldering process to these products is reflow soldering only.

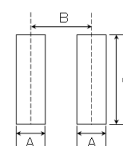

SMD Power Inductors (NR series/NR series H type/S type /V type)			
Type	A	B	C
NR 4010, NRS4010,			
NR 4012, NRS4012,	1.2	2.8	3.7
NR 4018, NRS4018			

unit:mm