

C4DE, Film, Metallized Polypropylene, DC Link, 380 uF, 10%, 400 VDC

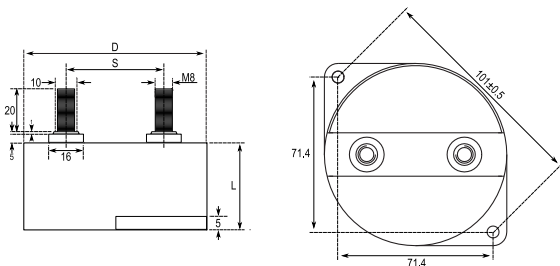

General Information	
Series:	C4DE
Dielectric:	Metallized Polypropylene
Style:	Can
RoHS:	Yes
Lead:	Threaded Studs M8
AEC-Q200:	No
Miscellaneous:	42 Amps (10kHz, 85C)
Notes:	The max torques are: Terminals M8 male: 7 N.m / Fixing Holes of the Plastic Case: 5 N.m

Dimensions	
D	84mm +/-0.5mm
L	64mm +/-2mm
S	45mm +/-1mm
LL	20mm NOM

Specifications	
Capacitance:	380 uF
Capacitance Tolerance:	10%
Voltage DC:	400 VDC
Temperature Range:	-40/+85°C
Rated Temperature:	85°C
Max dV/dt:	15 V/us
Resistance:	0.81 mOhms (10kHz)
Ripple Current:	100 Amps (10kHz 25C), 94 Amps (10kHz 45C), 73 Amps (10kHz 65C)
Inductance:	40 nH

Packaging Specifications	
Mounting:	Flange Mount
Packaging:	Bulk, Bag
Packaging Quantity:	12