

# Alchip™ - MVK-BP Series

- Bi-polar chip type for the circuit, of which polarity is frequently reversed
- Solvent resistant type (see PRECAUTIONS AND GUIDELINES)
- RoHS Compliant

MVK-BP

↑  
Bi-polar  
MVK



## ◆ SPECIFICATIONS

Items	Characteristics						
Category	-40 to +105°C						
Temperature Range	-40 to +105°C						
Rated Voltage Range	6.3 to 50V <sub>dc</sub>						
Capacitance Tolerance	±20% (M) (at 20°C, 120Hz)						
Leakage Current	I=0.05CV or 10μA, whichever is greater. Where, I : Max. leakage current (μA), C : Nominal capacitance (μF), V : Rated voltage (V) (at 20°C after 2 minutes)						
Dissipation Factor (tanδ)	Rated voltage (V <sub>dc</sub> )	6.3V	10V	16V	25V	35V	50V
	tanδ (Max.)	0.35	0.26	0.24	0.20	0.18	0.18
Low Temperature Characteristics (Max. Impedance Ratio)	Rated voltage (V <sub>dc</sub> )	6.3V	10V	16V	25V	35V	50V
	Z(-25°C)/Z(+20°C)	4	3	2	2	2	2
	Z(-40°C)/Z(+20°C)	10	8	6	4	3	3
Endurance	The following specifications shall be satisfied when the capacitors are restored to 20°C after the rated voltage is applied for 1,000 hours at 105°C, however the polarization shall be reversed every 250 hours.						
	Capacitance change	≤±30% of the initial value					
	D.F. (tanδ)	≤300% of the initial specified value					
	Leakage current	≤The initial specified value					
Shelf Life	The following specifications shall be satisfied when the capacitors are restored to 20°C after exposing them for 500 hours at 105°C without voltage applied. Before the measurement, the capacitor shall be preconditioned by applying voltage according to Item 4.1 of JIS C 5101-4.						
	Capacitance change	≤±25% of the initial value					
	D.F. (tanδ)	≤200% of the initial specified value					
	Leakage current	≤The initial specified value					

## ◆ DIMENSIONS [mm]

● Terminal Code : A

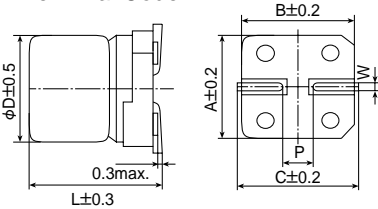

Size code	D	L	A	B	C	W	P
D60	4	5.7	4.3	4.3	5.1	0.5 to 0.8	1.0
E60	5	5.7	5.3	5.3	5.9	0.5 to 0.8	1.4
F60	6.3	5.7	6.6	6.6	7.2	0.5 to 0.8	1.9

## ◆ PART NUMBERING SYSTEM

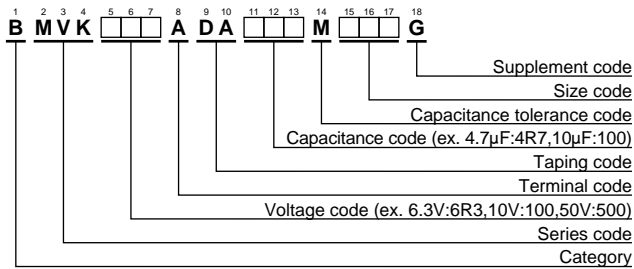

Please refer to "Product code guide (surface mount type)"

## ◆ MARKING

EX) 35V4.7μF



## ◆ STANDARD RATINGS

WV (V <sub>dc</sub> )	Cap (μF)	Size code	tanδ	Rated ripple current (mA <sub>rms</sub> /105°C, 120Hz)	Part No.	WV (V <sub>dc</sub> )	Cap (μF)	Size code	tanδ	Rated ripple current (mA <sub>rms</sub> /105°C, 120Hz)	Part No.
6.3	10	D60	0.35	14	BMVK6R3ADA100MD60G	50	0.10	D60	0.18	1.3	BMVK500ADAR10MD60G
	22	E60	0.35	25	BMVK6R3ADA220ME60G		0.22	D60	0.18	2.3	BMVK500ADAR22MD60G
	47	F60	0.35	39	BMVK6R3ADA470MF60G		0.33	D60	0.18	2.8	BMVK500ADAR33MD60G
10	33	F60	0.26	35	BMVK100ADA330MF60G		0.47	D60	0.18	3.4	BMVK500ADAR47MD60G
	4.7	D60	0.24	12	BMVK160ADA4R7MD60G		1.0	D60	0.18	5.5	BMVK500ADA1R0MD60G
16	10	E60	0.24	20	BMVK160ADA100ME60G		2.2	E60	0.18	10	BMVK500ADA2R2ME60G
	22	F60	0.24	32	BMVK160ADA220MF60G		3.3	E60	0.18	13	BMVK500ADA3R3ME60G
	3.3	D60	0.20	10	BMVK250ADA3R3MD60G		4.7	F60	0.18	16	BMVK500ADA4R7MF60G
35	2.2	D60	0.18	8.8	BMVK350ADA2R2MD60G						
	4.7	E60	0.18	15	BMVK350ADA4R7ME60G						
	10	F60	0.18	23	BMVK350ADA100MF60G						