

PC BATTERY CLIPS

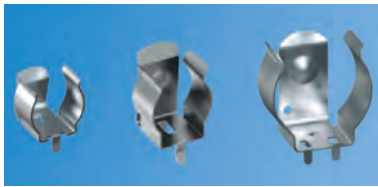

- Mounts securely to the PC board with advanced "Snap-In" design for thru hole mounting
- Reliable spring tension assures low contact resistance
- Low profile, economical design
- Retains battery securely to withstand shock and vibration
- AAAA, AAA, AA, N, 12V, 2/3A, 17-19mm



Refer to page 33 for Battery Contact Layout & Mounting Details

"AAAA"

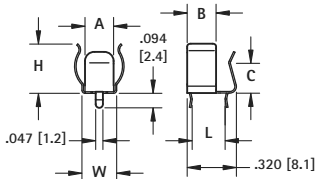

FIG. 1

"AAA" • "N" • "12V" • "AA" • "CR2"

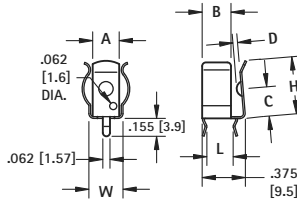
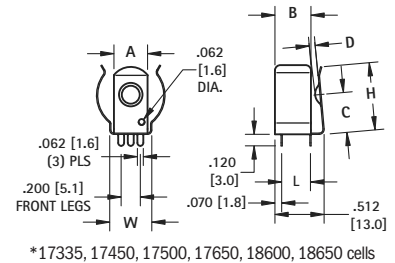

FIG. 2

"A" • 17-19mm*



*17335, 17450, 17500, 17650, 18600, 18650 cells

FIG. 3

MATERIAL: Spring Steel, Tin-Nickel Plate

CAT. NO.	FIG.	BATTERY SIZE	BATTERY DIAMETER	A	B	C	D	H	L	W	MATERIAL THICKNESS
51	1	"AAAA"	.300-.350 (7.6-8.9)	.187 (4.8)	.187 (4.8)	.194 (4.9)	-	.320 (8.1)	.214 (5.4)	.226 (5.7)	.010 (.25)
82	2	"AAA" • "N" • "12V"	.375-.460 (9.5-11.7)	.250 (6.4)	.250 (6.4)	.280 (7.1)	.040 (1.0)	498 (12.7)	.228 (5.8)	.296 (7.5)	.010 (.25)
52	2	"AA" • "CR2" • "A"	No Ears	.250 (6.4)	-	.280 (7.1)	.032 (0.8)	498 (12.7)	.228 (5.8)	.250 (6.4)	.010 (.25)
92	2	"AA" • "CR2"	.531-.665 (13.5-16.9)	.312 (7.9)	.250 (6.4)	.359 (9.1)	.050 (1.3)	593 (15.1)	.228 (5.8)	.369 (9.4)	.012 (.30)
2915	2	"AA" • "CR2"	.531-.665 (13.5-16.9)	.312 (7.9)	.250 (6.4)	.359 (9.1)	.050 (1.3)	593 (15.1)	.228 (5.8)	.376 (9.5)	.015 (.38)
54	3	"A" • 17-19mm*	.669-.748 (17.0-19.0)	.350 (8.9)	.375 (9.5)	.385 (9.8)	.062 (1.6)	653 (16.6)	.300 (7.6)	.438 (11.1)	.012 (.30)

*Battery Reference: 2/3A, 17335, 17450, 17500, 17650, 18500, 18650 cells

P.C. BUTTON & SPRING CONTACTS



- Space saving design installs directly onto the PC board
- Suitable for .062 (1.57) to .093 (2.36) PC boards
- Reliable spring tension assures low contact resistance
- Ideal for self-contained battery compartments



COIL SPRING

"CR2" • "A"

(+) POSITIVE BUTTON

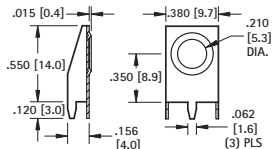

(-) NEGATIVE SPRING

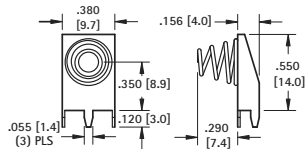

MATERIAL:
Frame: .015 (.38) Steel, Tin Plate
Spring: .025 (.64) Dia. Spring Steel, Nickel Plate

CAT. NO. 628

"AAA" • "AA" • "N" • "12V"

(+) POSITIVE BUTTON

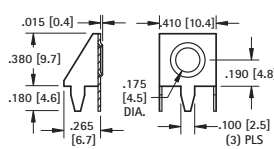

(-) NEGATIVE SPRING

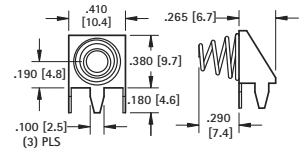

MATERIAL:
Frame: .015 (.38) Steel, Tin Plate
Spring: .025 (.64) Dia. Spring Steel, Nickel Plate

CAT. NO. 629

MATERIAL:
Frame: .015 (.38) Steel, Tin-Nickel Plate

CAT. NO. 595

LEAF SPRING

"AA" • "CR2" • "A"

MATERIAL: .012 (.30) Spring Steel, Tin-Nickel Plate

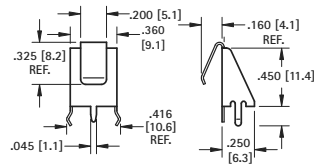
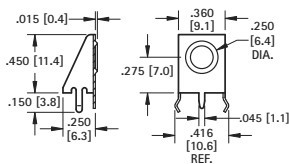

CAT. NO. 590

"AAA" • "N" • "12V"

MATERIAL: .010 (.25) Spring Steel, Tin-Nickel Plate

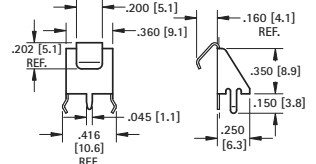
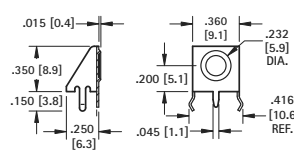

CAT. NO. 591

CAT. NO. 596