

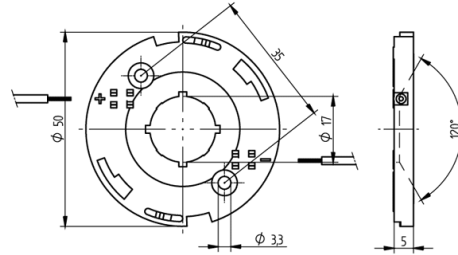

Technology for Light

COB connector Ø 50 mm for LED array 19 x 19 mm 47.319.2021.50



0,25 - 0,5 mm²



0,5 mm²



COB connector Ø 50 mm for LED array 19 x 19 mm

47.319.2021.50

Technology for Light

DESCRIPTION

With integrated reflector interface
 Screw mounting: for screws M3 and locking washer
 Max. torque for screw fixing 0.5 Nm*
 Strip length: 7-1 mm
 Polarity of LED must be observed
 Specifications of LED manufacturer must be observed
 cURus: For limited applications
 VDE-Reg. No. E289
 *Please note the max torque of the COB manufacturer

Mounting method 1:	Screw mount
LED Typ:	CIM-14 / CLM-14 / CXM-14, PB16H01, M045, PB26H01, LP30N3-84N-B131299, Xuan1919, Opto 30W, CL-U034/U036/U038/U720/U721, V13 - Gen. 7, PACB 032/PACF 57, LC016D / 19D / 26D / 33D, PB19H01, SAW x1564A, ZC12/18, LES 14.5 (19 x 19 x 0.9 mm), 15W L-COB G2, CVM-14, CHM-9 / CHM-11, Soleriq S15, COB-N series, CL-L030/032/091, DMC 114/118/125/128, SLE G6 LES 17, SLE G6/G7 LES 15, G17, Soleriq S13 - 19x19 mm
LED manufacturer:	Seoul Semiconductor, Citizen, Luminus, Liteon, Lextar, LEDtech, Itswell, Prolight Opto, Bridgelux, Sunpu, Everlight, Edison, Xicato, LG Innotek, Samsung, Vossloh-Schwabe, Tridonic, OSRAM Opto Semiconductors
Prefixation of COB:	No
Conductor cross-section:	0.5 mm
Weight:	5
Approval:	cURus
Material:	Housing: PBT Contacts: CuSn
cULus file no.:	E-345385
Mounting method 2:	P2F fixing with 28.902.-102
Pkg.:	504
Rating:	3A / 150 VDC
Product name:	COB connector Ø 50 mm for LED array 19 x 19 mm

Suitable for the following LED models:

LED Manufacturer	LED Type	More Information
Seoul Semiconductor	ZC12/18	http://www.seoulsemicon.com
LEDtech	LP30N3-84N-B131299	http://www.ledtech.com.tw
Everlight	Xuan1919	http://www.everlight.com
Vossloh-Schwabe	DMC 114/118/125/128	http://www.vossloh-schwabe.com
Citizen	CL-U034/U036/U038/U720/U721	http://ce.citizen.co.jp
Sunpu	G17	http://www.sunpuled.com
Prolight Opto	PACB 032/PACF 57	http://www.prolightopto.com
Edison	Opto 30W	http://www.edison-opto.com.tw
Tridonic	SLE G6/G7 LES 15	http://www.tridonic.com
OSRAM Opto Semiconductors	Soleriq S13 - 19x19 mm	http://www.osram-os.com
Itswell	COB-N series	http://www.itswell.com



Technology for Light

COB connector Ø 50 mm for LED array 19 x 19 mm 47.319.2021.50

Liteon	M045	http://optoelectronics.liteon.com
Samsung	LC016D / 19D / 26D / 33D	http://www.samsung.com
Tridonic	SLE G6 LES 17	http://www.tridonic.com
Seoul Semiconductor	SAW x1564A	http://www.seoulsemicon.com
Citizen	CL-L030/032/091	http://ce.citizen.co.jp
Bridgelux	V13 - Gen. 7	http://www.bridgelux.com
Lextar	PB16H01	http://www.lextar.com
Lextar	PB19H01	http://www.lextar.com
Lextar	PB26H01	http://www.lextar.com
OSRAM Opto Semiconductors	Soleriq S15	http://www.osram-os.com
Luminus	CHM-9 / CHM-11	http://www.luminus.com
Luminus	CVM-14	http://www.luminus.com
LG Innotek	15W L-COB G2	http://ledlighting.lginnotek.com
Luminus	CIM-14 / CLM-14 / CXM-14	http://www.luminus.com
Xicato	LES 14.5 (19 x 19 x 0.9 mm)	https://www.xicato.com/